

SMOOTHLINE HALF ROUND GUTTER



IT'S EFFICIENT

Because there are no square corners to gather silt and debris, HALF ROUND gutter is largely self-cleaning. Half round gutter is also more efficient than most other fascia gutters. It empties water faster because it has greater water carrying capacity than many other forms of gutters, and efficiently channels even the smallest amount of water to the centre of the gutter for disposal.

IT'S EASY

NO EXTERNAL BRACKETS... That's right! Stratco Smoothline gutter does not need external brackets for fixing - that means easier installation and no corners to attract spiders. "No brackets" makes painting Smoothline gutter easier as well.

IT'S VERSATILE

Stratco Smoothline is available for fixing to steel or timber fascias. On Stratco steel fascia, using the classic design of the "Clickfast" suspension clip it's a breeze, and a similar type of clip called the "timber fix clip" allows easy installation on timber fascias as well. Re-falling of Smoothline is made easier with the use of Stratco suspension clips. Smoothline is stronger than traditional half round gutters, when fixed to a fascia, because there is more material sitting flush on the fascia, with the extra bend and suspension rib providing stiffness as well.

IT'S LESS EXPENSIVE

Stratco Smoothline is significantly less expensive per metre (installed) than the standard external bracket style half round guttering system... a very important reason to specify Stratco's breakthrough design, "Smoothline".

IT'S ATTRACTIVE

The smooth flowing lines and lack of external brackets give Smoothline much more "eye" appeal. Smoothline looks right on any building project.

TRADITIONAL HALF ROUND GUTTER

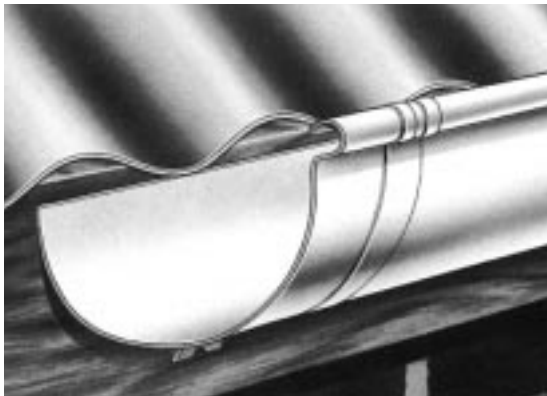

SPANISH STYLE

Of course if you require traditional "Spanish style" half round gutter, Stratco will be happy to supply that too. The true half round shape has a timeless appeal, and has been a favourite of architects, building designers, and homeowners for years. Heavy gauge, zinc plated, external brackets provide the traditional appearance for this product. So now you have the choice.

EXTERNAL BRACKETS

To ensure easy flow of water in the gutter, and assist in leafy areas, external brackets are most effective, as leaves and twigs can get caught on internal straps, blocking the gutter and reducing water flow. Stratco manufacture its decorative external bracket from heavy gauge steel for maximum strength, and galvanise them for increased life. The bracket increases the visual appeal of the gutter where a "Spanish" effect is desired, and they are easily screwed to either timber or steel fascias. Brackets can be provided in colour where you wish them to match the gutter colour.

MATERIALS

SPECIFICATION

Stratco "Smoothline" and "Traditional" spanish style half round gutters are supplied in Zinalume and a comprehensive colour range. Zinalume steel has an AZ150 coating, and complies with Australian Standard AS1397-1984.

COLOUR OPTIONS

Both styles of gutter are available in a full range of colours to suit your outdoor environment.

TENSILE STRESS GRADES

Depending on the state in which you live, the material may be manufactured in either "High tensile G550" or "Standard G300" grades of steel. The numbers G550 and G300 represent the tensile strength in MPa. Both have different advantages. High tensile steel is lighter and stronger, and better resists incidental impact damage, such as that caused by ladders. Gutters produced from standard stress grades also perform well and offer advantages in ease of formability and of forming self made mitres.

TYPE OF GUTTER	TENSILE STRENGTH	FINISH	BASE METAL THICKNESS (B.M.T)	TOTAL COATED THICKNESS (T.C.T)	MASS (KG/LIN METRE)	YIELD (LIN METRE/TONNE)
SMOOTHLINE	6550	ZINCALUME	0.420	0.470	0.96	1035
		COLOUR	0.420	0.495	0.98	1018
	6300	ZINCALUME	0.500	0.550	1.20	829
		COLOUR	0.500	0.575	1.18	842
TRADITIONAL HALF ROUND GUTTER	6550	ZINCALUME	0.420	0.470	0.96	1035
		COLOUR	0.420	0.495	0.98	1018
	6300	ZINCALUME	0.500	0.550	1.20	829
		COLOUR	0.500	0.575	1.18	842

TECHNICAL DETAILS

ACCESSORIES

MITRES AND CORNERS: The type of material available will also determine the accessory range available. High tensile gutter is best mitred using pre-made cast internal and external corners, which are simply riveted and sealed into position. One mitre cut on each joining length is all that is required to obtain a neat, practical, and aesthetically pleasing finish using these pre-made cast corners. Standard gutter can be formed on site, by the tradesperson who has sheetmetal knowledge or factory pre-made internal and external mitres are available.

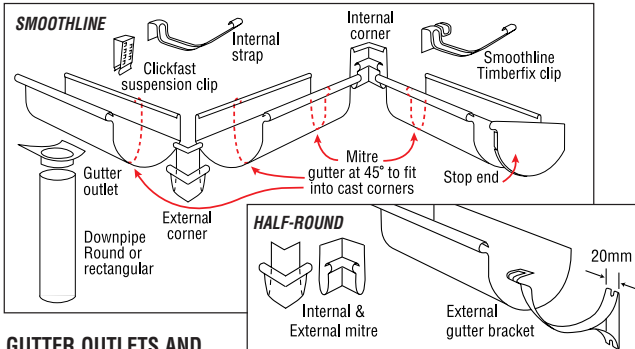

GUTTER OUTLETS AND STOP ENDS:

Sculptured gutter outlets are available in a variety of sizes to suit the half round shape of both smoothline and traditional half round gutter. In addition stop ends are available in both "left hand" and "right hand" combinations to allow you to complete a gutter run where it is not being mitred.

ARCHITECTURAL SPECIFICATION: The gutter shall be Stratco Smoothline (or Traditional Half Round) Gutter. Gutter material shall be protected steel sheet to Australian Standard AS1397 with a minimum yield stress of 300MPa (Grade G 300) or 550 MPa (Grade G 550) with an AZ150 zinc-aluminium coating with or without an oven baked paint film of selected colour. The gutter shall be installed in accordance with manufacturers recommendations. The fascia clips/brackets supplied shall be attached to the fascia/barge at a maximum of 1.2 metre centres, using the recommended fasteners. Flashings shall be supplied in compatible materials as specified. All work shall be fixed in a workman like manner, leaving the job clean and weather tight. All debris (screws, rivets, cuttings and filings, etc) shall be cleaned off daily.

INSTALLATION

- Expansion joints should be used where any single gutter run, with fixed ends, exceeds 22 metres.
- Water flowing from copper surfaces should not flow onto Zinalume or galvanised steel.
- Do not use lead flashing in conjunction with Zinalume guttering and avoid allowing water to flow from an inert catchment area onto Zinalume guttering.
- A minimum fall of 1 in 500 is required for an eaves gutter, and overflow spouts may need to be provided in areas of high rainfall.
- Make sure that the gutter is free from swarf, filings, rivets, and other metal objects after installation.
- Downpipe size and spacing should be calculated in accordance with AS 2180 - Metal Rainwater goods - Selection and installation.

HI-TENSILE	STANDARD

SELECTION USE AND MAINTENANCE There are a number of factors that influence the life and performance of Stratco guttering. These are 1) The material selection, 2) Maintenance, 3) Installation and 4) The environment. Details of how these may affect your project can be found in the brochure titled, "Selection, Use and Maintenance of Stratco Steel Products". Please obtain, and read, a copy of this brochure when purchasing, installing, or using all Stratco products. If you still have questions please contact your local Stratco office for advice.

FIXING

SMOOTHLINE: TO STRATCO STEEL FASCIA

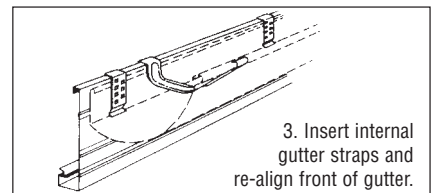
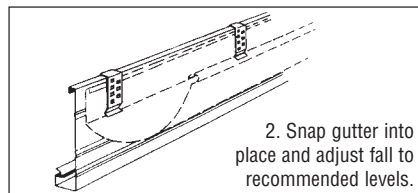
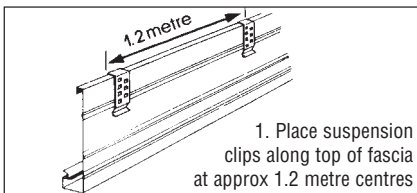

SMOOTHLINE: TO TIMBER FASCIA WITH TIMBER FIX CLIP

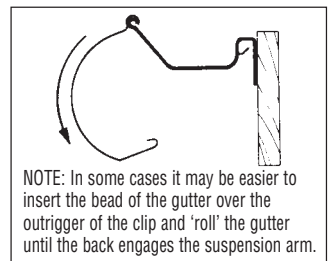
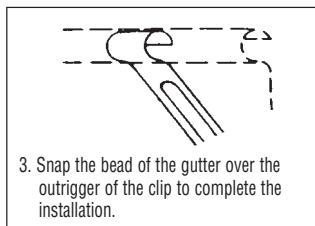
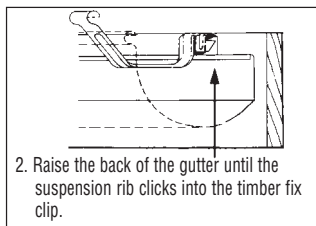
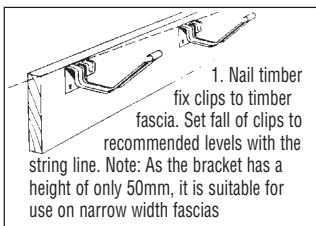

TRADITIONAL SPANISH STYLE HALF ROUND: TO TIMBER FASCIA (WITH EXTERNAL BRACKETS)

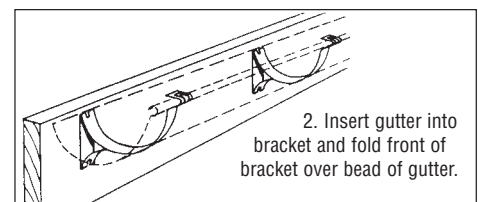
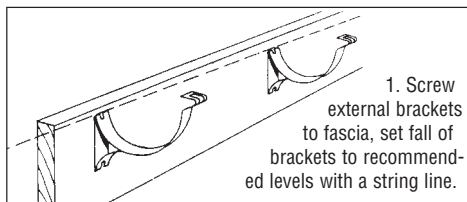

ALL TECHNICAL DATA AND INFORMATION IS CORRECT AT TIME OF PUBLICATION. STRATCO METAL RESERVE THE RIGHT TO ALTER DIMENSIONS, TOLERANCES ETC... WITHOUT NOTICE. ZINCALUME® IS A REGISTERED TRADEMARK. © COPYRIGHT STRATCO (AUSTRALIA) PTY LTD NOVEMBER 1998 (A.C.N. 007 550 754)